

All Dimensions are in MM

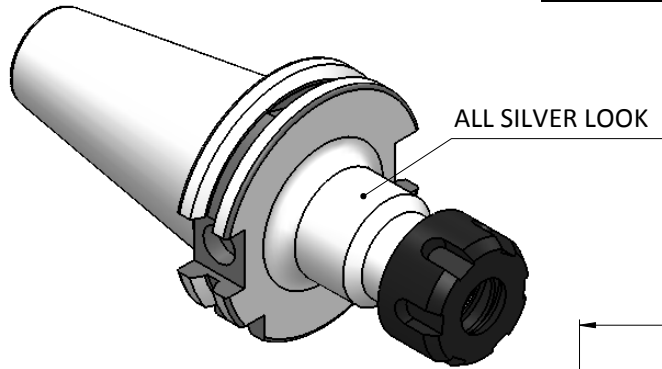

Rev.No.	Ch.Let	Alterations	Date	Sign.	Appd.

CUSTOMER APPROVAL REQUIRED

APPROVED BY

DATE

FOR QUOTATION PURPOSE ONLY

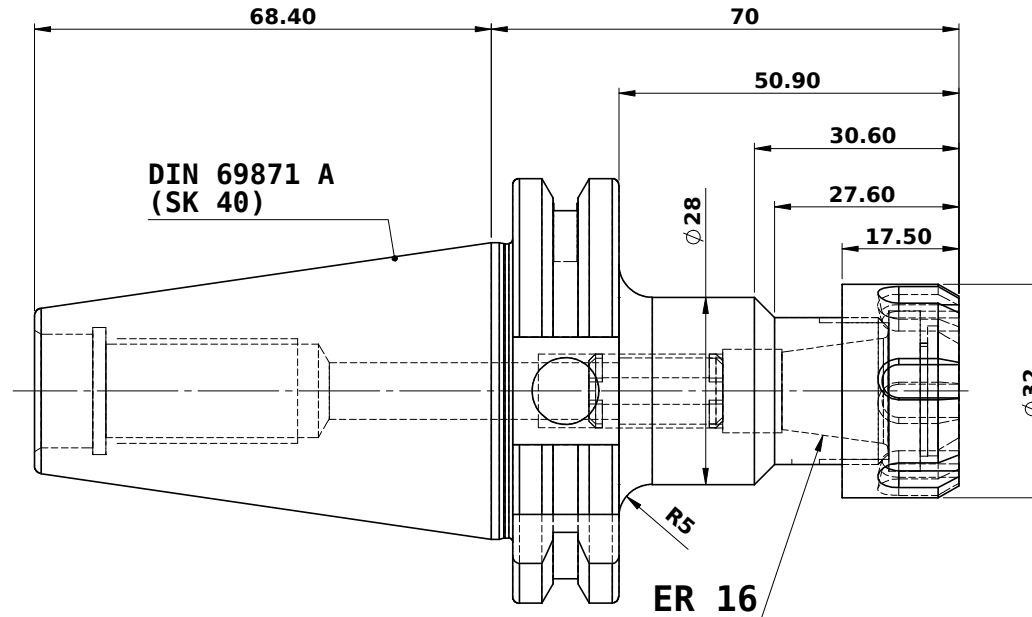

LABEL :

**Spannzangenfutter
ER collet chuck holder
DIN69871 AD SK40
ER16 x 70 mm
G6.3/ 15000**

**MARKING : DIN 69871 AD SK40 CCH ER16 H070
G6.3 15000 U/MIN**

WEIGHT :1.0 Kg.

BALANCING 6.3G@15000 RPM

	μ m	0.012	0.025	0.05	0.1	0.2	0.4	0.8	1.6	3.2	6.3	12.5	25	50
GRADES		N1	N2	N3	N4	N5	N6	N7	N8	N9	N10	N11	N12	
SYMBOLS		▽▽▽	▽▽	▽	▽	▽	▽	▽	▽	▽	▽	▽	▽	~
TOLERANCE FREE DIMENSIONS TOLERANCE		2016		NAME		DATE		WEMAG 2002261.0300						
Dimns.	Dia	Length	DRAWN	ELA	22/02									
0.5 to 3	± 0.05	± 0.10	CHECKED	RVL	22/02									
3 to 6	± 0.10	± 0.15	APPROVED											
6 to 30	± 0.15	± 0.20	SCALE : NTS		QTY. :	PART NAME:		DRAWING No.						
30 to 120	± 0.20	± 0.25	COLLET CHUCK HOLDER		SK40 CCH ER16 070 WW									
120 to 500	± 0.30	± 0.50			REV.									

ITEM NO.	PART NUMBER	DESCRIPTION	QTY.
1	SK40 CCH ER16 070 WW	COLLET CHUCK HOLDER	1
2	FTNUTER16	COLLET NUT	1
3	SCW7/16-20UNF	STOPPER SCREW	1